

# NOW ON VIEW

## GALLERY LEVEL

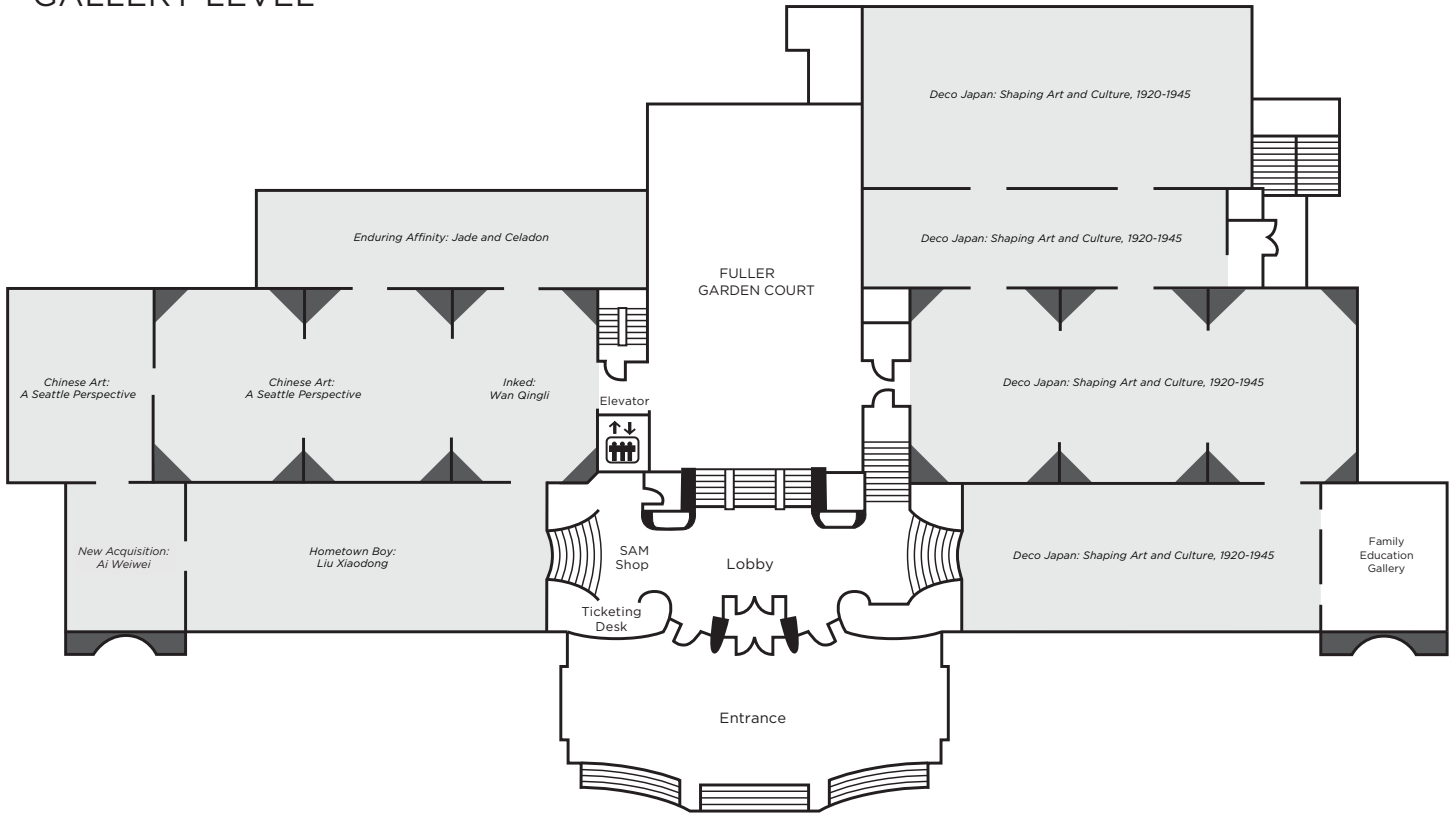

## LOWER LEVEL

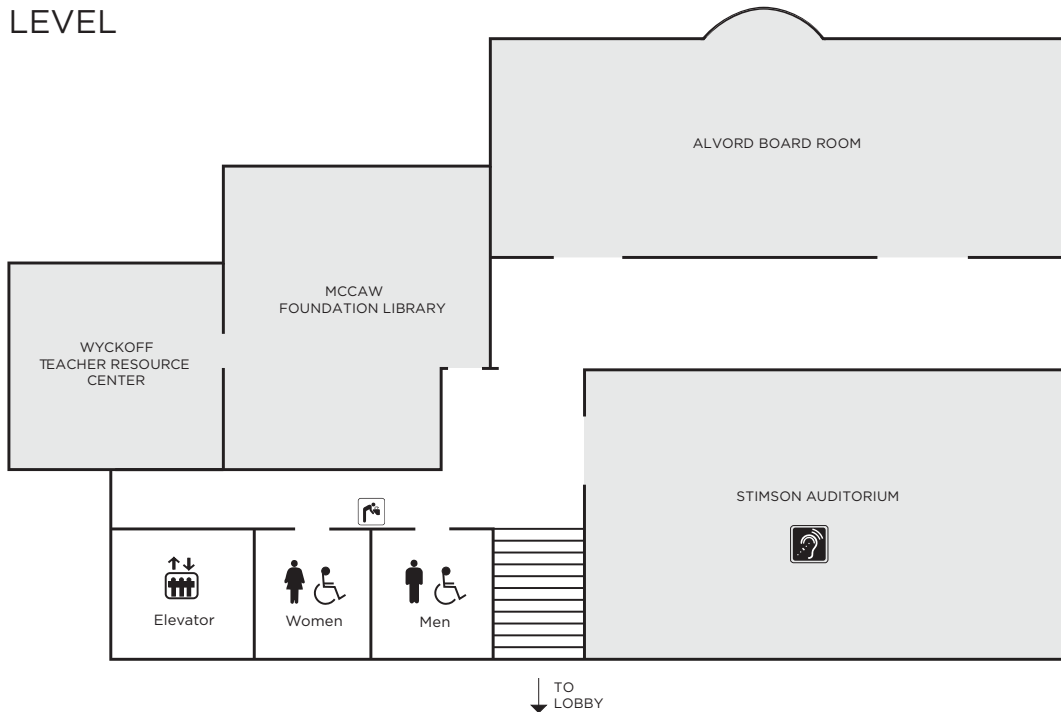

# MAP AND GUIDE

## Welcome to the Asian Art Museum

This historic Art Deco building originally housed the Seattle Art Museum's entire collection, from 1933 to 1991. After building an additional museum downtown, SAM devoted the beloved Volunteer Park museum to its world-renowned collection of Asian art. The Asian Art Museum strives to exhibit Asian art from across cultures and across time, including highlights from contemporary artists working in Asia today.

## Special Programs and Events

Free First Saturdays

First Saturday of every month, 11 am–2 pm

Kids create art that connects with world cultures at the Asian Art Museum. Each Free First Saturday has a theme and features drop-in workshops, special performances and more! Designed for kids ages 3–12 and their parents/guardians. Free and open to the public.

## Museum Hours

Monday–Tuesday	Closed
Wednesday–Sunday	10 am–5 pm
Thursday	10 am–9 pm

## McCaw Foundation Library Hours

Thursday & Friday	2–5 pm
Saturday	10 am–5 pm
Summer Saturday Hours	10 am–2 pm

## Ann P. Wyckoff Teacher Resource

### Center Hours

Thursday & Friday	2–5 pm
Saturday	10 am–5 pm
Summer Saturday Hours	10 am–2 pm

## SAM Members Are Always Free!

Administration	206.654.3100
TDD	206.344.5267
Customer Service	206.654.3210
SAM Shop	206.654.3160
McCaw Library	206.654.3202
Wyckoff Teacher Resource Center	206.654.3186

Dwarf  
Chinese  
Tang period, 618–907, early 7th–early 10th century  
Ceramic  
8 5/16 x 4 3/16 x 3 1/4 in.  
Seattle Art Museum, Eugene Fuller Memorial Collection, 48.247

